

**Goodhue
County**
MINNESOTA

2025
Annual Township
Officers Meeting

Agenda

- Welcome and Introductions
- County Board of Commissioners
- Administration
- Public Works
- Land Use Management
- Goodhue Soil and Water Conservation District
- Finance
- County Attorney

Welcome & Introduction

- Scott Arneson, County Administrator
- Brad Anderson, Chair of the Goodhue County Board of Commissioners
- Stacy Lance, Executive Admin. Asst. Special Projects Lead
- Introduction of Nick Lemmer, Outreach & Communication Specialist



Goodhue County Board of Commissioners



Brad Anderson
District 2
Chair



Susan Betcher
District 5
Vice Chair

Goodhue County Board of Commissioners



Linda Flanders
District 1



Todd Greseth
District 3

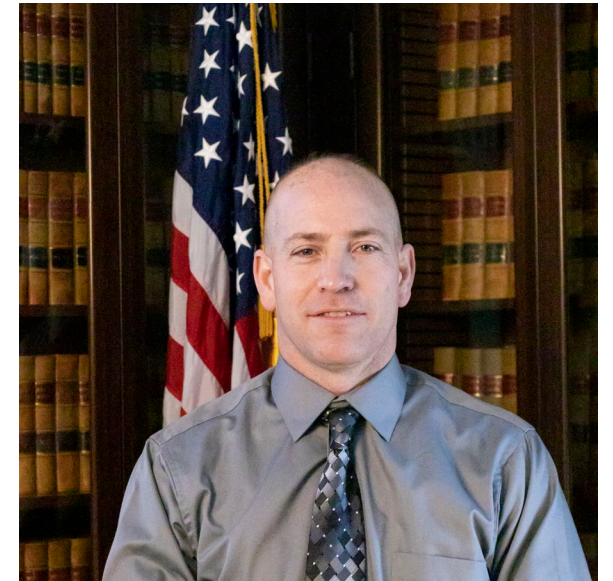

Jason Majerus
District 4



Goodhue County Administration

- Staff
 - Scott Arneson – County Administrator
 - Andrea Benck – andrea.benck@goodhuecountymn.gov – 651.385.3251
 - Stacy Lance – stacy.lance@goodhuecountymn.gov – 651.385.3001
 - Nick Lemmer – nick.lemmer@goodhuecountymn.gov – 651.385.3249
 - Call or email with any questions regarding the website/board or meeting information.

Goodhue County Board of Commissioners

- Continue to meet on the 1st and 3rd Tuesday of each month.
 - May – Meeting at Kenyon City Hall
 - July – Meeting at Cannon Valley Fair
 - August – Meeting at Goodhue Co. Fair
- Meetings are also held in hybrid format using Microsoft Team's.
- All meetings are scheduled and located on the County Calendar located on the website.
<https://goodhuecountymn.gov>



Subscriptions & Notifications

- Go to goodhuecountymn.gov scroll to the bottom of the home page, click the orange subscribe button.
- Use the search engine “notifications”
- Enter your email
- Select to receive notifications for the information you selected

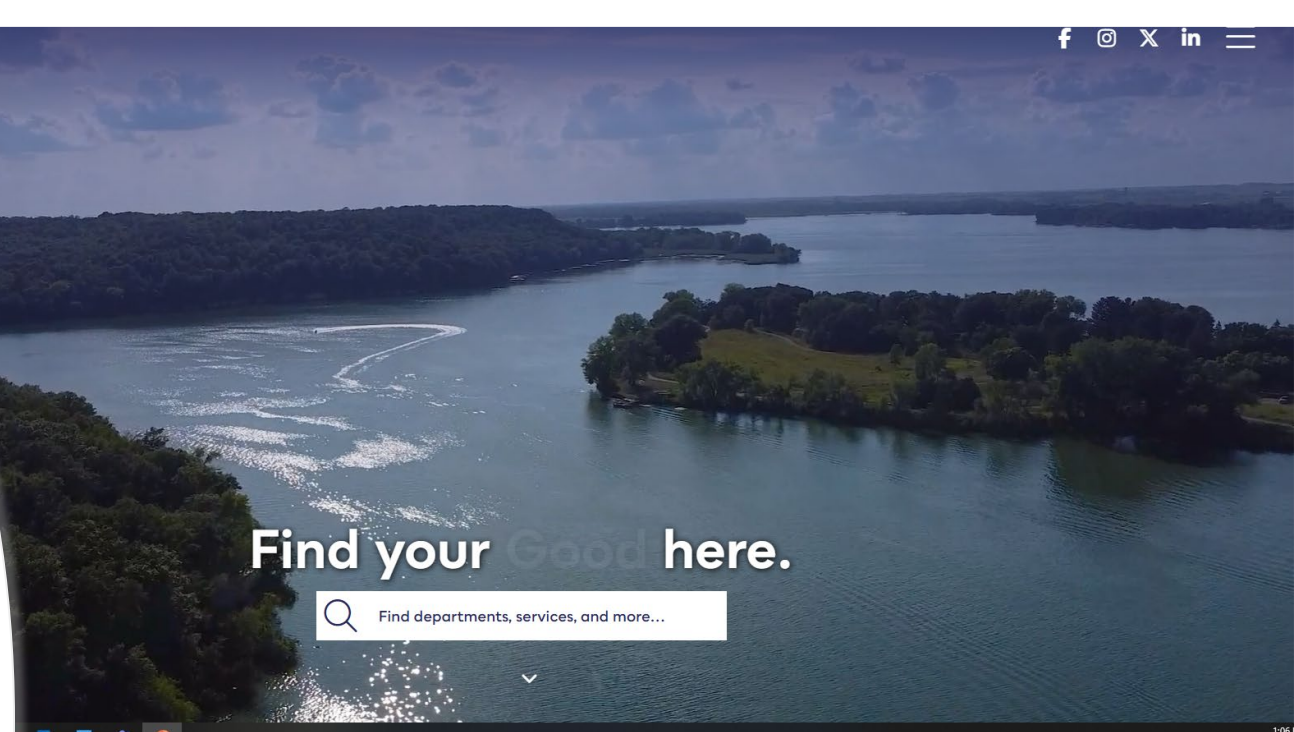

Agenda Center

Find past and upcoming meeting agendas from Goodhue County boards and committees.

2025 Meetings

January 27, 2025 - 5:00pm Board of Adjustment	Agenda	-	-
January 27, 2025 - 6:00pm Planning Advisory Commission	Agenda	-	-
January 23, 2025 - 8:30am Technology Committee	Agenda	-	-
January 21, 2025 - 9:00am	Agenda	-	Video

Notifications

Sign up to receive notifications when agendas are posted to the Goodhue County website.

Select which agendas you'd like to receive notifications for and manage your subscriptions at any time.

[Notification Options](#)



Public Notice: Notice of Public Hearing - Update Local Option Sales Tax Project List

January, 15, 2025
[Read More →](#)



Public Notice: Notice of Public Hearing - Release Old County State Highway 1 in Sections 11, T112N, R15W

[Read More →](#)
January, 10, 2025

[View All News](#)

[Subscribe](#)

Communications Update

- County Brand
- Website
 - goodhuecountymn.gov
 - Township pages
 - Questions/changes contact Nick Lemmer
- Communications Plan Priorities
 - Building relationships
 - Awareness of services & programs
 - Customer experience



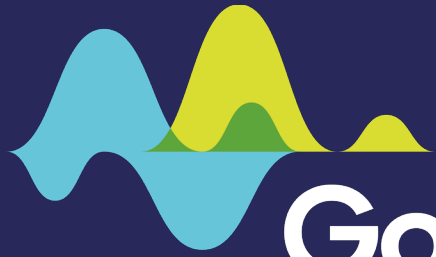

**Goodhue
County**
MINNESOTA

Public Works

2025 Road & Bridge
Construction Program

Agenda

- County Construction Projects
- Township Culvert/Bridge Replacement Projects
- Staff Introductions
- Bridge Safety Inspection
- County Bid Partnering
- Town Road and Bridge Allotments

2025-2029 Proposed Road & Bridge Program

YEAR	ROAD #	TYPE OF PROJECT	TERMINI	LENGTH MILES
2025	CSAH 2	GRADING	CSAH 5 – TH 61	4.8
	CSAH 8	REPLACE BRIDGE 25516	0.3 MILES NORTH OF CSAH 9	0.1
	CSAH 7	REPLACE BRIDGE 25530	2.8 MILES NORTH OF TH 19	0.1
2026	CSAH 2	INITIAL CONCRETE PAVING	CSAH 5 – TH 61	4.8
	CSAH 11	GRADING	CR 55 – EAST COUNTY LINE	5.2
	CSAH 7	REPLACE BRIDGE L0415	2.3 MILES SOUTH OF TH 61	0.1
	CSAH 7	REPLACE BRIDGE L0416	2.4 MILES SOUTH OF TH 61	0.1
2027	CSAH 1	GRADING / PAVING	CSAH 1 – 2500' EAST OF CSAH 25	1.0
	CSAH 1	CONCRETE PAVING / ROUNDABOUT	CR 53 – BENCH STREET	5.0
	CSAH 1	CONCRETE REHAB	BENCH STREET – TH 61	1.1
	CSAH 11	INITIAL BITUMINOUS SURFACING	CR 55 – EAST COUNTY LINE	5.2
	CSAH 11	MILL & OVERLAY	PINE ISLAND – CR 55	1.5
	CSAH 11	MINI-ROUNDABOUT / MILL & OVERLAY	IN PINE ISLAND	2.2
	CR 45	MILL & OVERLAY	CHURCH – CSAH 9	0.7
	CR 47	MILL & OVERLAY	CSAH 9 – 1.8 MILES NORTH	1.8
	CR 49	MILL & OVERLAY	20 TH AVE – TH 56	1.0
	CR 50	FDR & AGGREGATE SURFACING	TH 57 – CSAH 7	5.0
	CR 43	REPLACE BRIDGE 25573	2.2 MILES NORTH OF CSAH 11	0.1
	CR 56	REPLACE BRIDGE L0544	0.9 MILES NORTH OF CSAH 1	0.1

2025-2029 Proposed Road & Bridge Program

YEAR	ROAD #	TYPE OF PROJECT	TERMINI	LENGTH MILES
2028	CSAH 11	GRADING	CR 27 – 3 RD AVE IN PINE ISLAND	6.5
	CSAH 17	RECONDITIONING & BITUMINOUS PAVING	TH 20 – 3.8 MILES EAST	3.8
	CSAH 30	BITUMINOUS PAVING	TH 56 – CSAH 1	5.8
	CSAH 12	REPLACE BRIDGE L0470	0.3 MILES WEST OF CSAH 1	0.1
	CSAH 14	REPLACE BRIDGE 25534	4.0 MILES NORTH OF CSAH 9	0.1
2029	CSAH 11	INITIAL BITUMINOUS SURFACING	CR 27 – 3 RD AVE IN PINE ISLAND	6.5
	CSAH 16	GRADING	TH 58 – EAST COUNTY LINE	6.1
	CSAH 62	MUNICIPAL GRADING	IN PINE ISLAND	0.2
	CSAH 62	CONCRETE REHAB	IN PINE ISLAND	0.2
	CSAH 30	REPLACE BRIDGE 25564	1.5 MILES WEST OF TH 57	0.1
	CR 44	REPLACE BRIDGE L0519	1.6 MILES EAST OF TH 56	0.1

Goodhue County 2025 Projects

Bridge
Replacement
CSAH 7
Br. 25530
0.1 Miles

Grading
CSAH 2
CSAH 5 – TH 16
4.8 Miles

Bridge
Replacement
CSAH 8
Br. 25516
0.1 Miles

Bridge Project

Grading Project

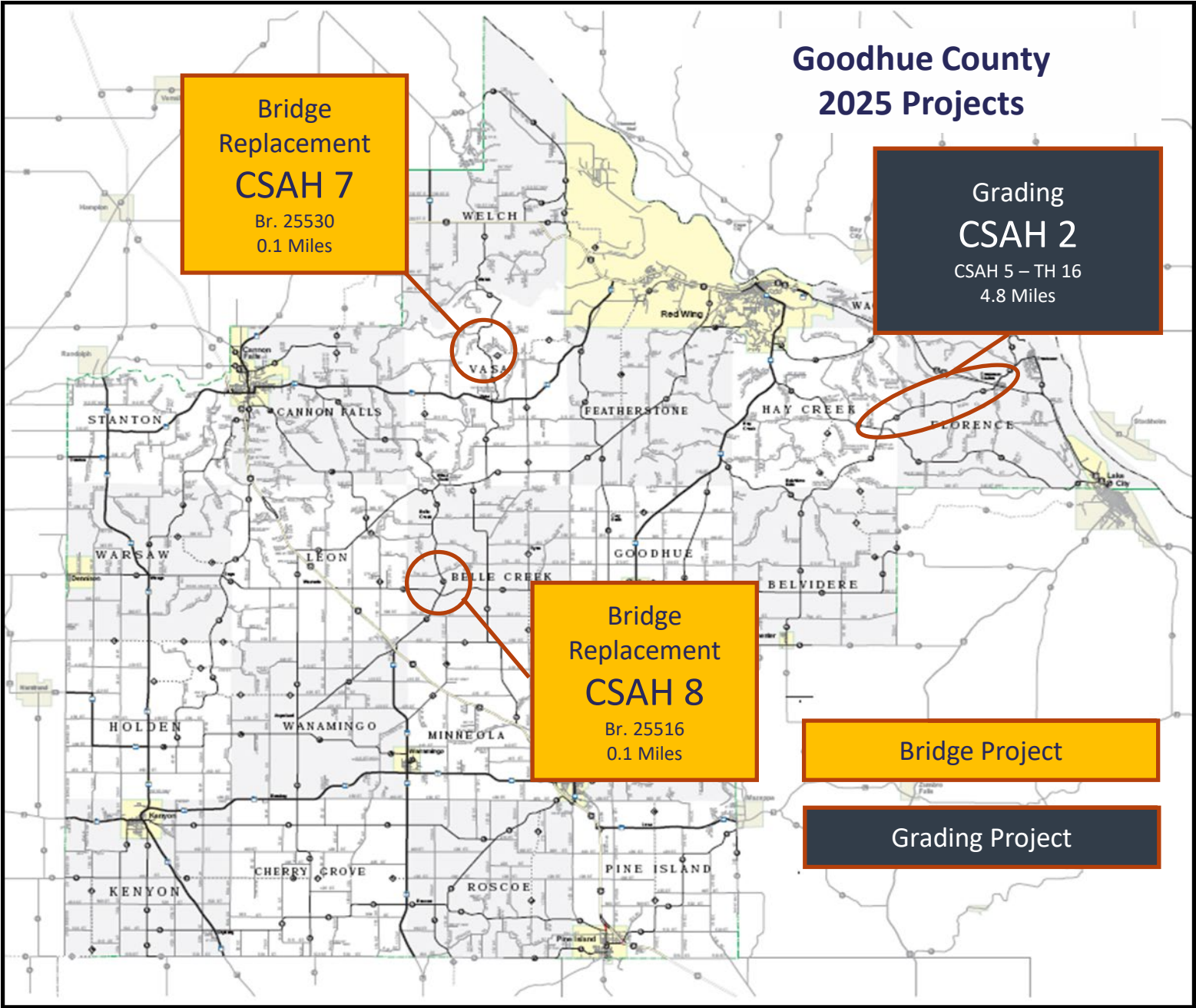

Goodhue County 2026 Projects

Bridge
Replacements
CSAH 7
Br. L0415 & L0416
0.1 Miles

Concrete Paving
CSAH 2
CSAH 5 – TH 16
4.8 Miles

Grading
CSAH 11
CR 55 – East County Line
5.2 Miles

Bridge Project

Grading Project

Concrete Paving

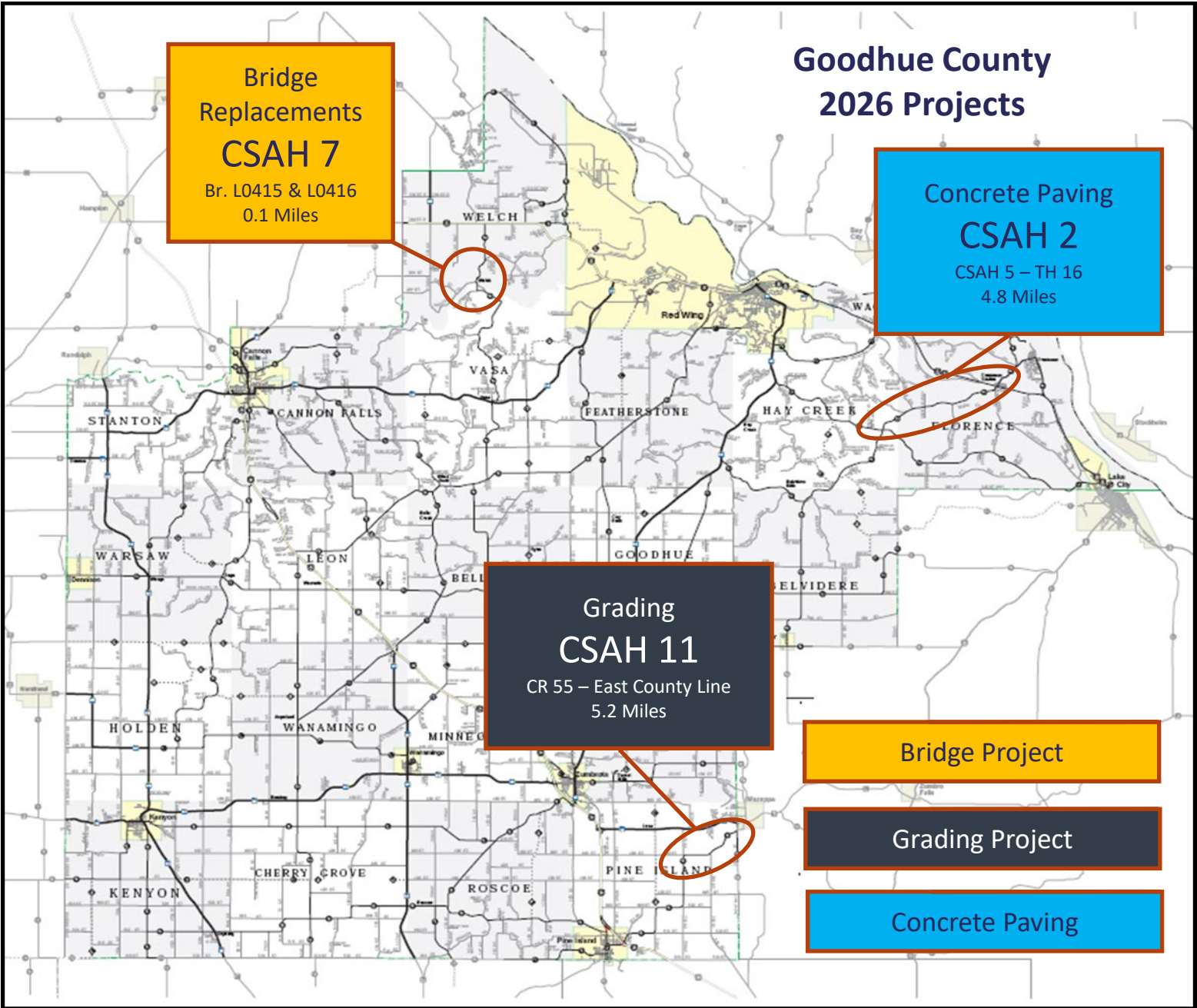

Goodhue County 2027 Projects

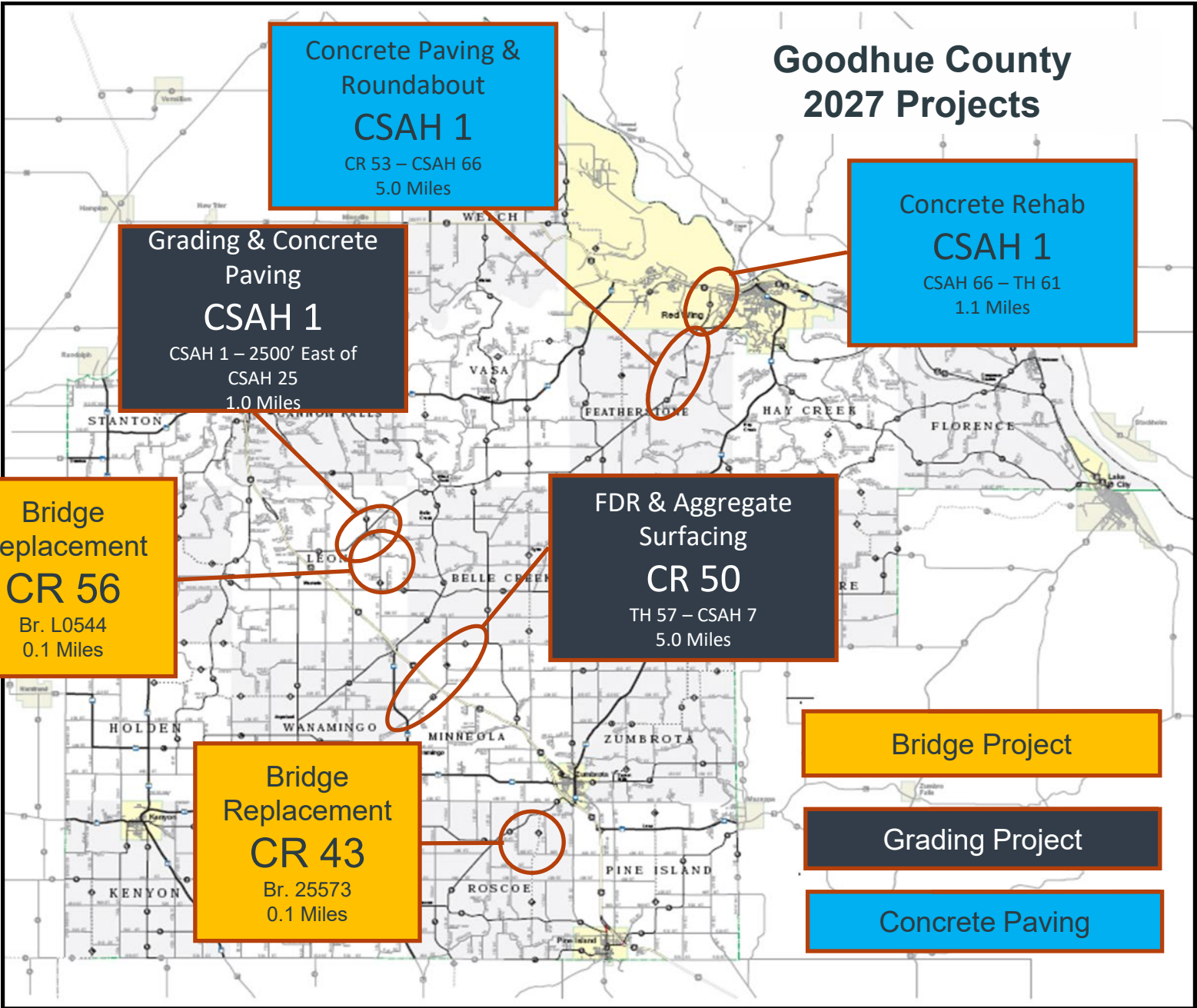

Goodhue County 2027 Bituminous Projects

Mill & Overlay
CR 49
20th Ave – TH 56
1.0 Mile

Mill & Overlay
CR 47
CSAH 9 – 1.8 miles North
1.8 Miles

Initial Surfacing
CSAH 11
CR 55 – East County Line
5.2 Miles

Mill & Overlay
CR 45
Church – CSAH 9
0.7 Miles

Mill & Overlay
CSAH 2
CSAH 16 – Bellechester Limits
0.6 Miles

Mill & Overlay / Mini-
Roundabout
CSAH 11
Pine Island – CR 55
3.7 Miles

Bit. Paving Project

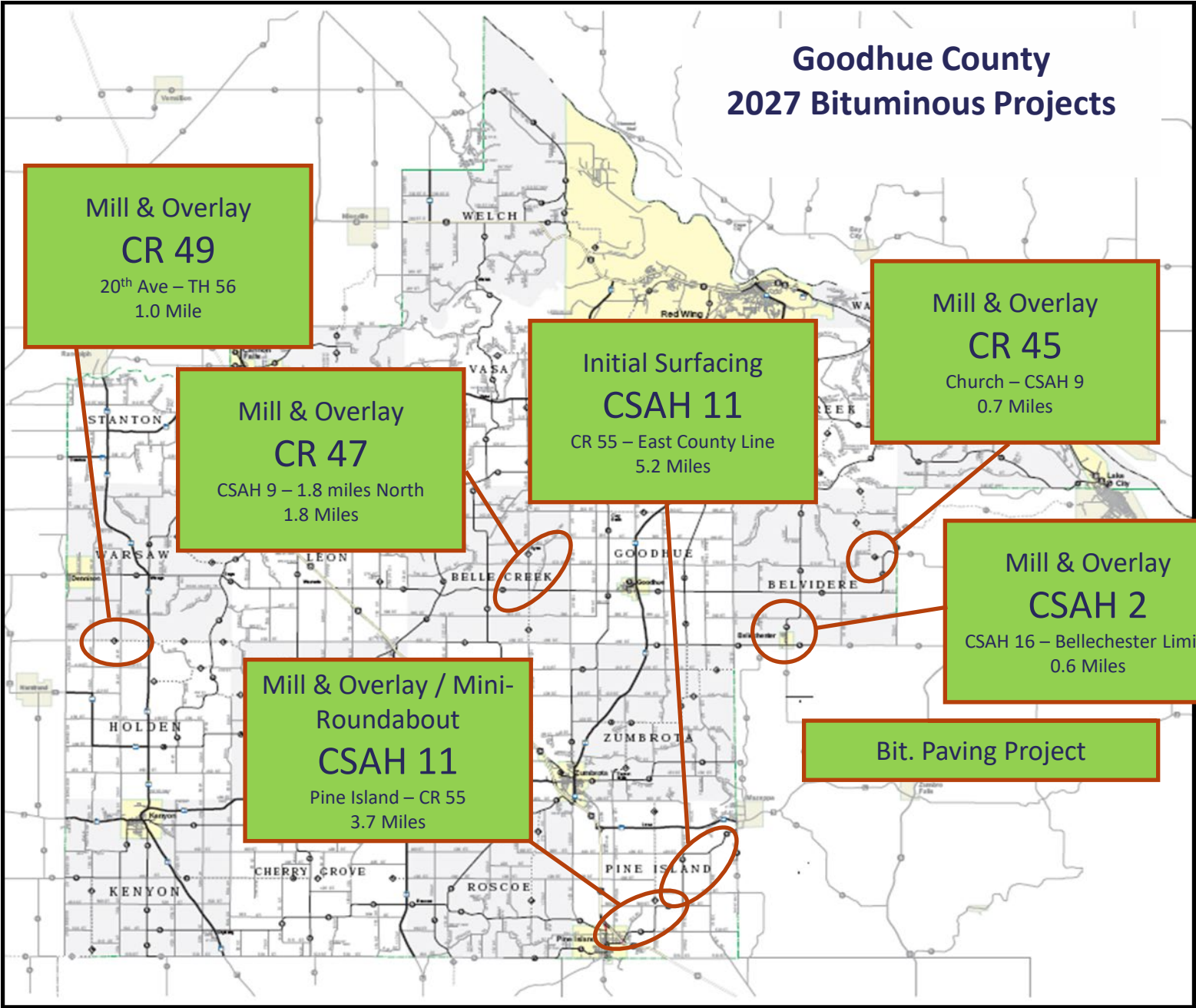

Goodhue County 2028 Projects

Reconditioning & Bit.
Paving
CSAH 17
TH 20 – 3.8 miles East
3.8 Miles

Bridge Replacement
CSAH 14
Br. 25534
0.1 Miles

Bituminous Paving
CSAH 30
TH 57 – CSAH 1
5.8 Miles

Grading
CSAH 11
CR 27 – 3rd Ave in Pine Island
6.5 Miles

Bridge Replacement
CSAH 12
Br. L0470
0.1 Miles

Bridge Project

Bit. Paving Project

Grading Project

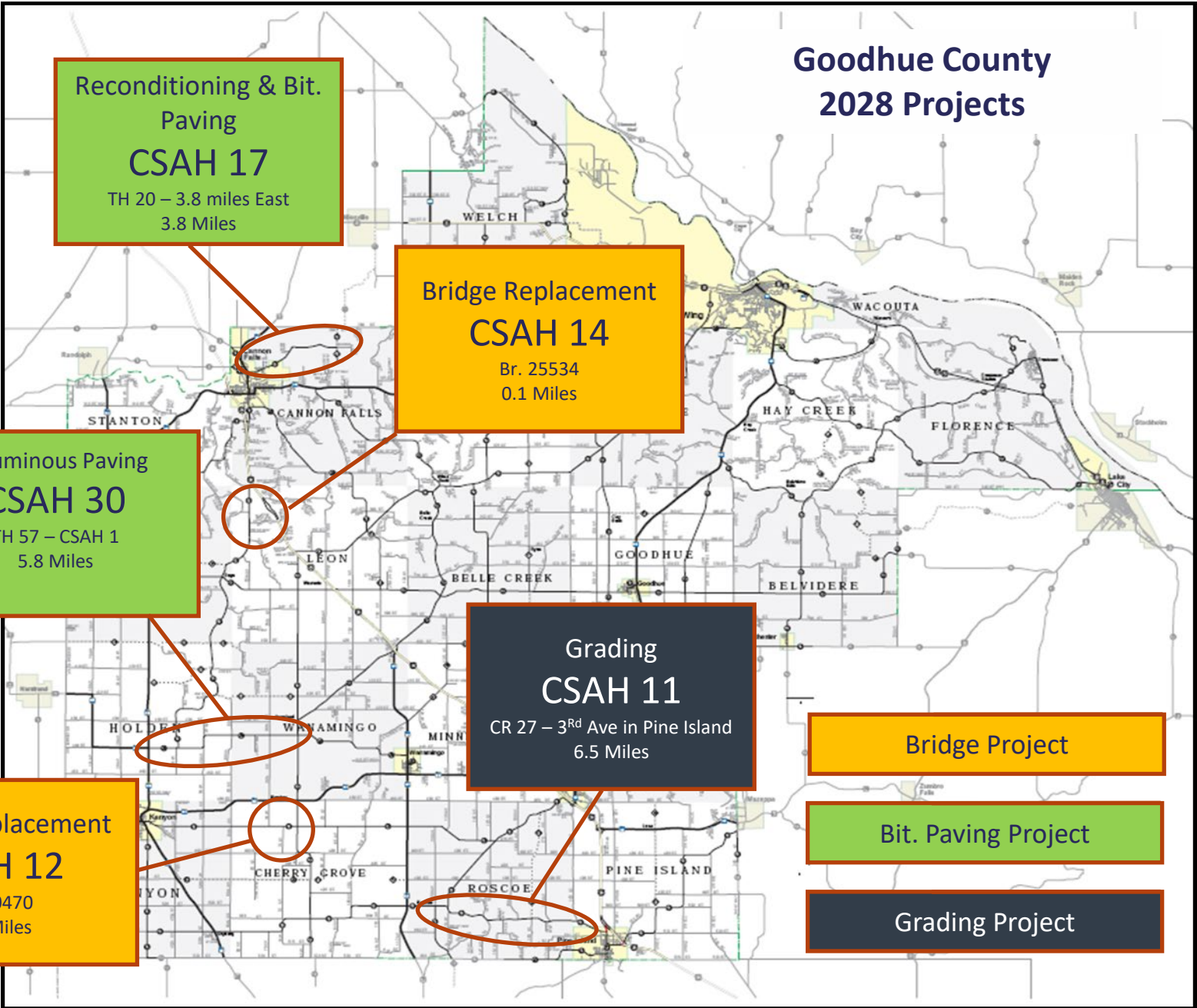

Goodhue County 2029 Projects

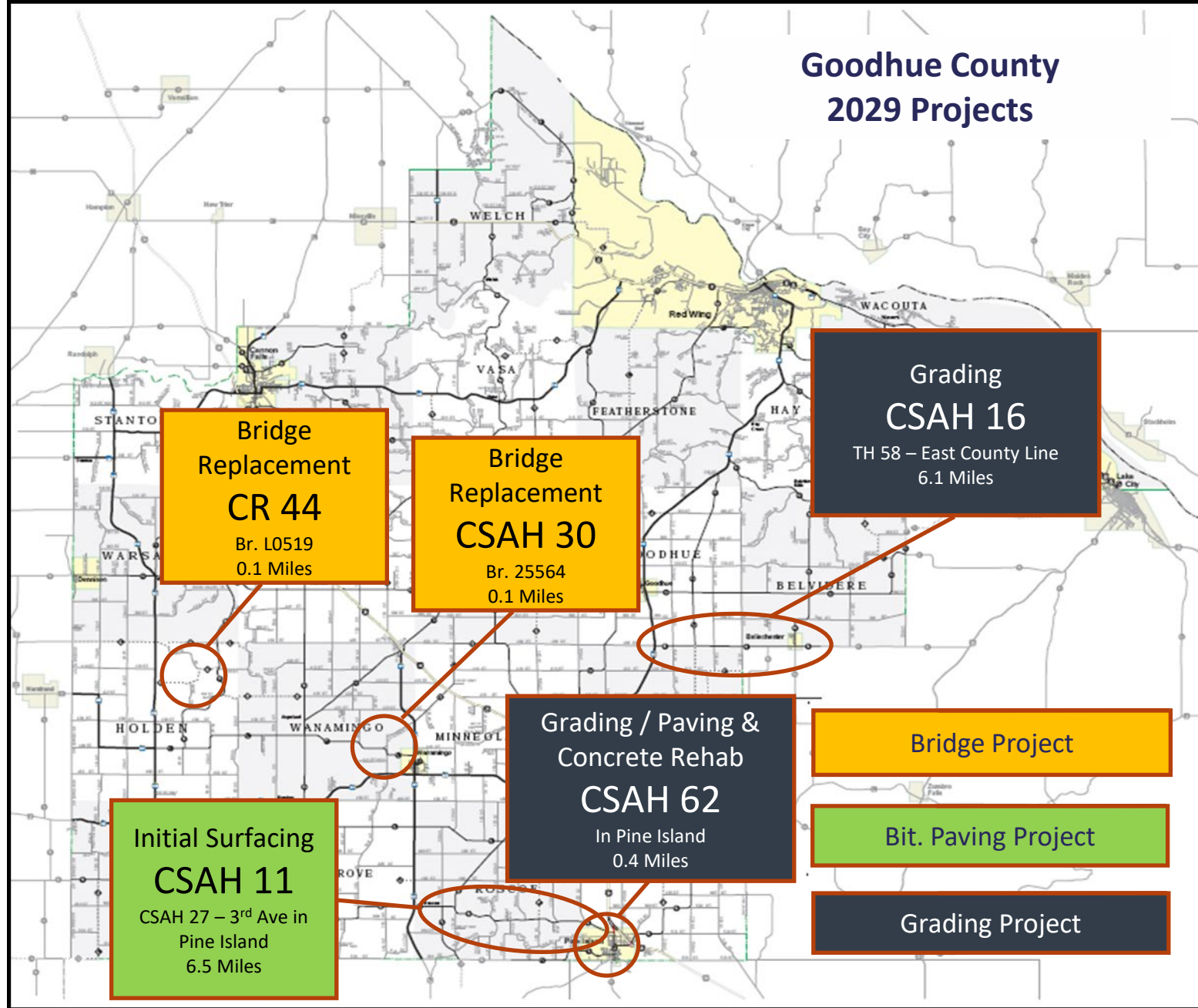

Bridge Replacement
CR 44
Br. L0519
0.1 Miles

Bridge Replacement
CSAH 30
Br. 25564
0.1 Miles

Grading
CSAH 16
TH 58 – East County Line
6.1 Miles

Grading / Paving &
Concrete Rehab
CSAH 62
In Pine Island
0.4 Miles

Initial Surfacing
CSAH 11
CSAH 27 – 3rd Ave in
Pine Island
6.5 Miles

Bridge Project

Bit. Paving Project

Grading Project

Township Bridge Projects



THESE PROJECTS ARE SUBJECT TO AVAILABLE FUNDING



2025-2029 Township Bridge Program

YEAR	BRIDGE NO.	ROAD AUTHORITY	ROAD NAME/NUMBER
2025	L0549	WELCH TWP	WELCH TRAIL
	R0901	KENYON TWP	GOODHUE AVE
2026	L0679	GOODHUE TWP	370 TH ST
	L0740	PINE ISLAND TWP	195 TH AVE
	L0612	VASA TWP	325 TH ST
2027	97629	ZUMBROTA TWP	460 TH ST
	L6837	HOLDEN TWP	430 TH ST
	25J07	BELLE CREEK TWP	360 TH ST
2028	6169	FEATHERSTONE TWP	320 TH ST
	L9646	WARSAW TWP	GOODHUE AVE
	L0693	CITY OF GOODHUE	BROADWAY ST
2029	97377	FEATHERSTONE TWP	305 TH ST
	N/A	FEATHERSTONE TWP	320 TH ST
	N/A	LEON TWP	357 TH ST

Bridges highlighted in yellow require an executed township bridge agreement between the County and the Township. GCPW is currently working on agreements for 2027.

2025 Potential Township Bridge Projects

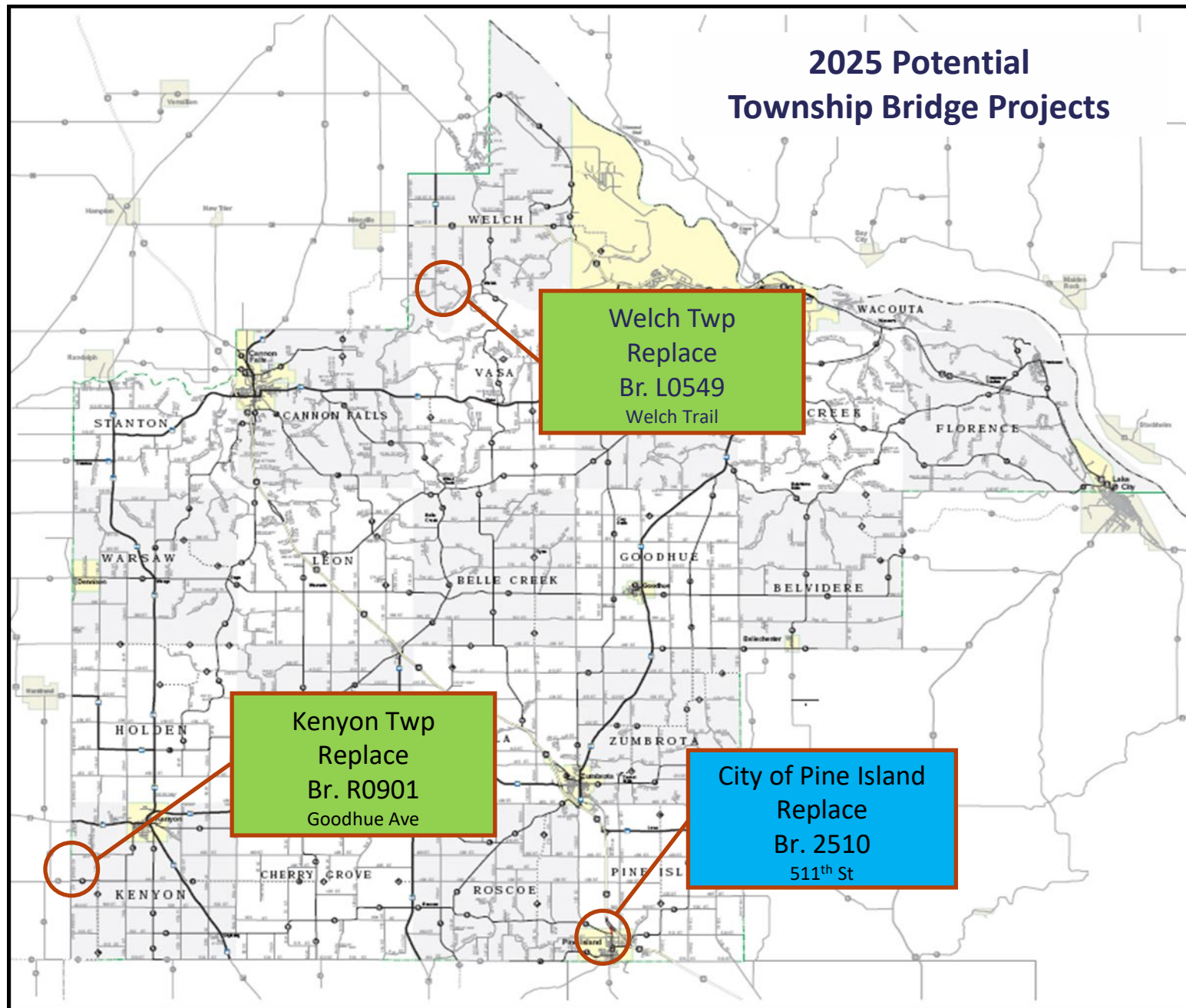

2026 Potential Township Bridge Projects

Vasa Twp
Replace
Br. L0612
325th St

Goodhue Twp
Replace
Br. L0679
370th Ave

Pine Island Twp
Replace
Br. L0740
195th Ave

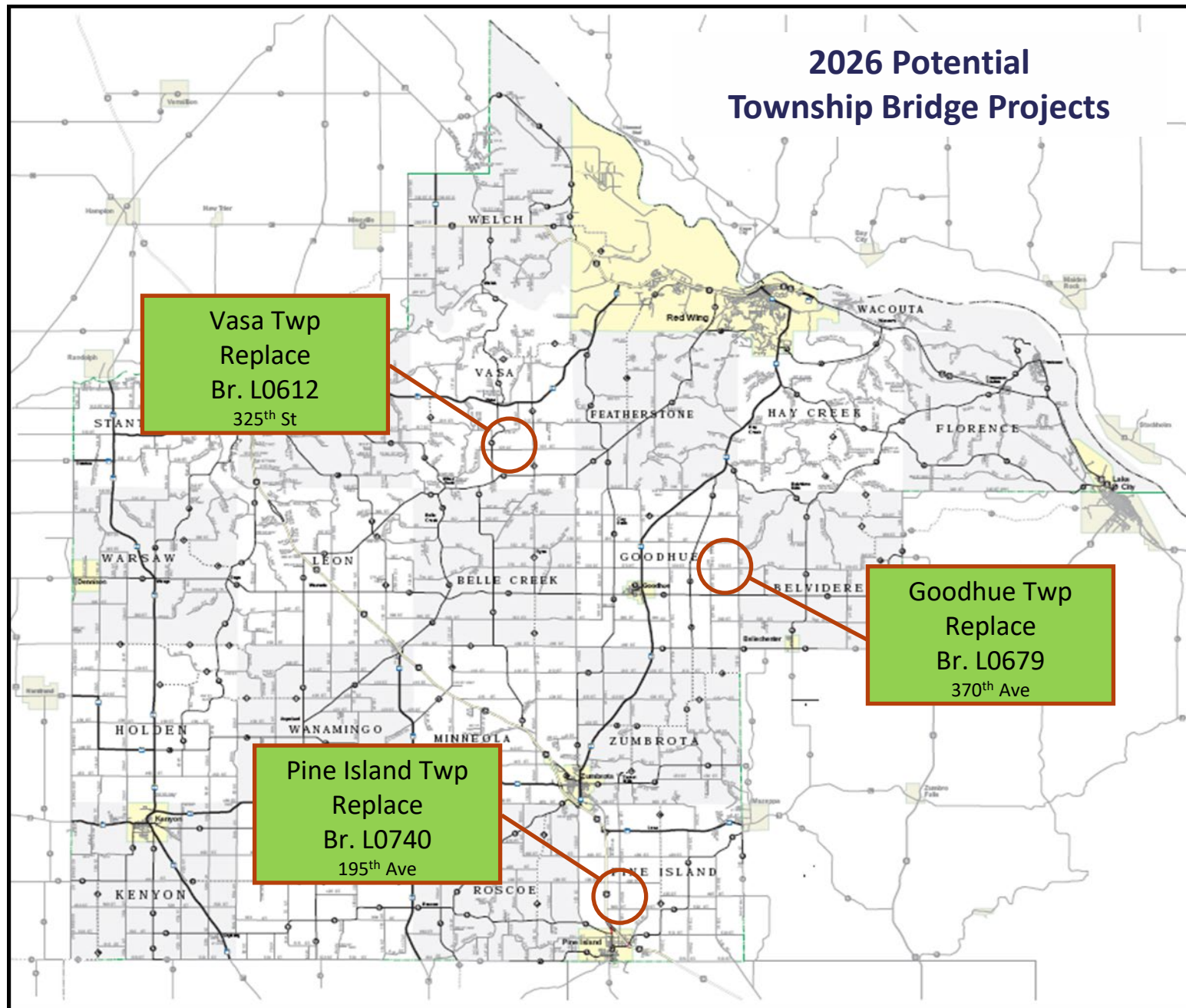

2027 Potential Township Bridge Projects

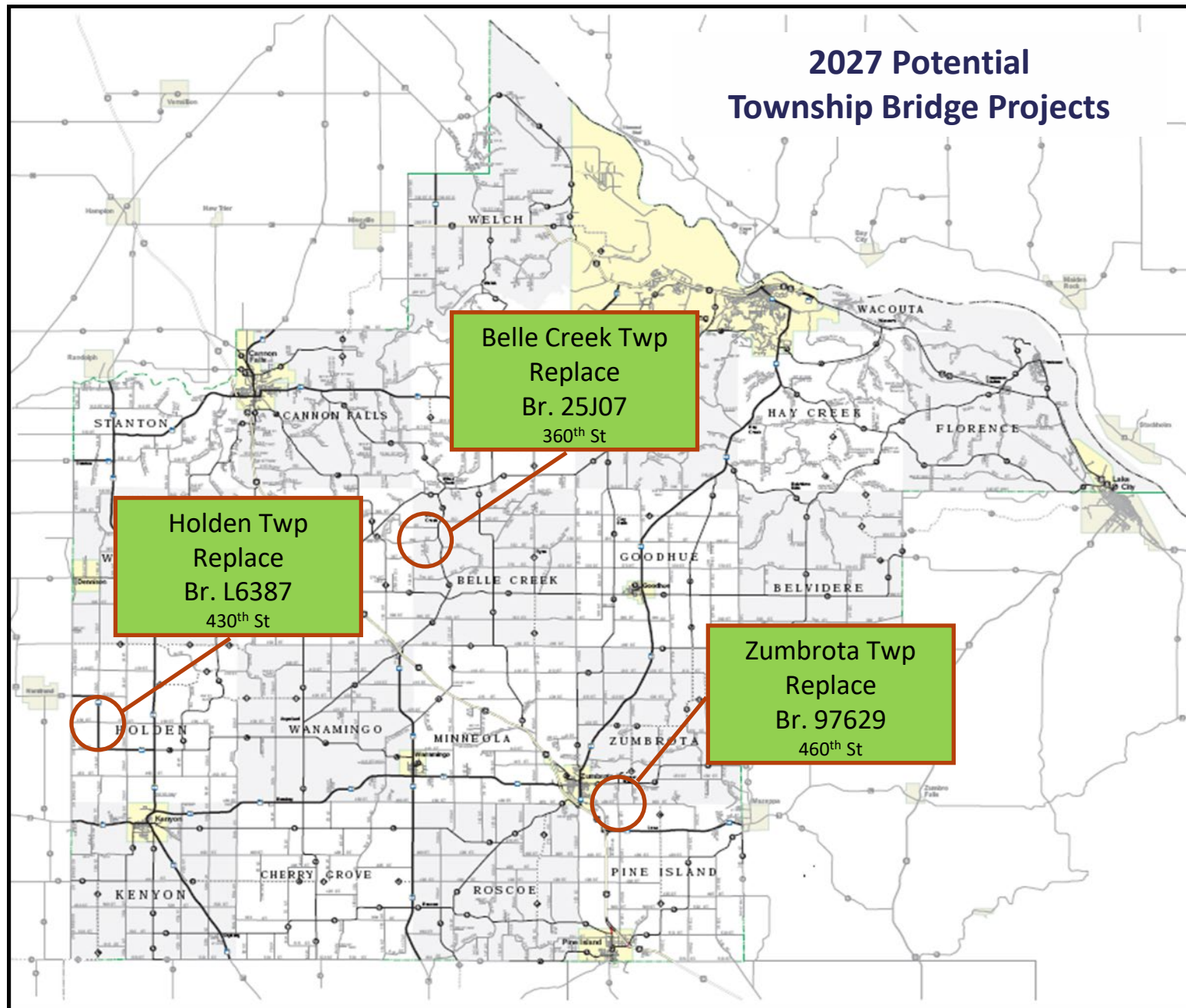

2028 Potential Township Bridge Projects

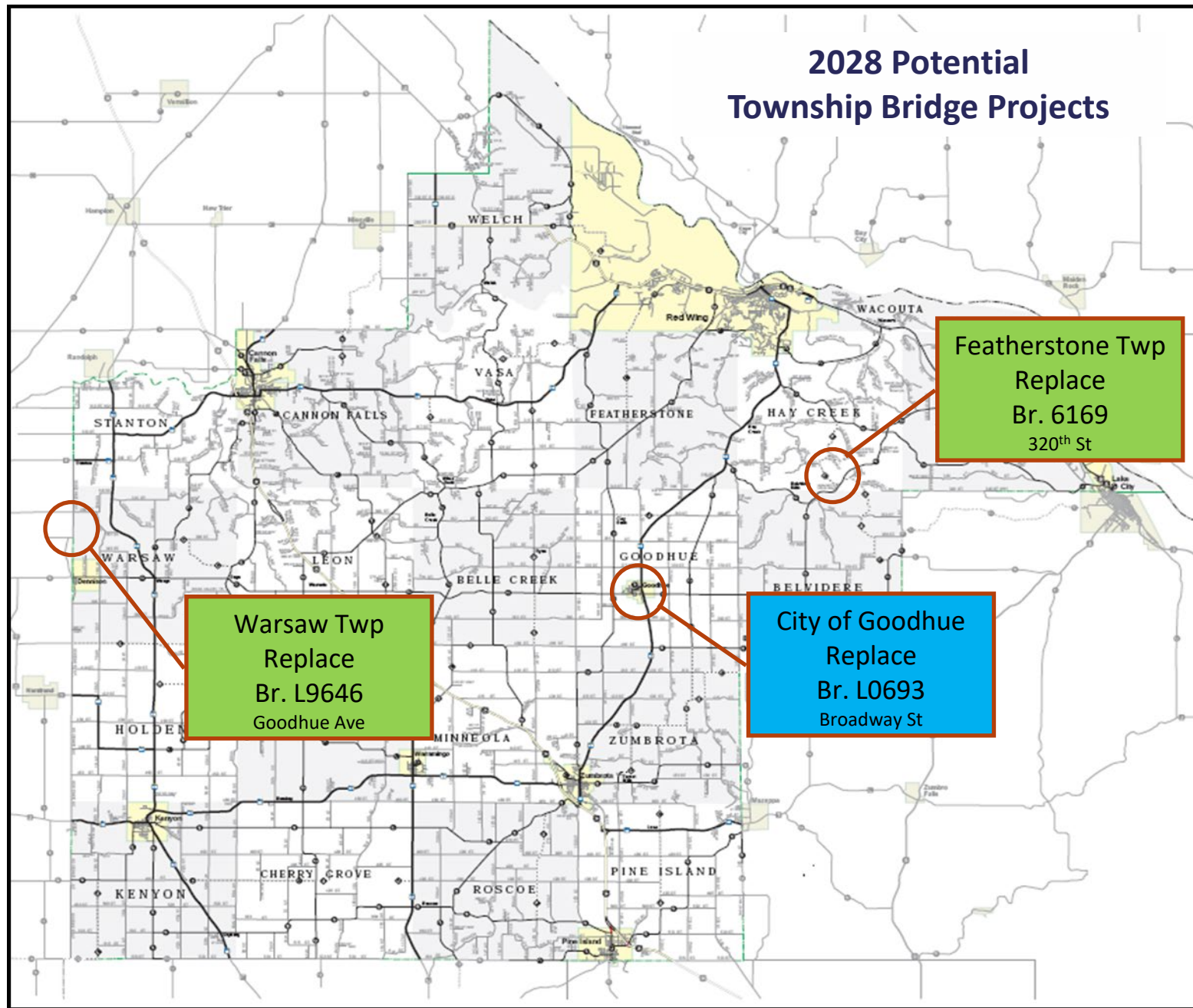

2029 Potential Township Bridge Projects

Leon Twp
Replace
No #
357th St.

Featherstone Twp
Replace
Br. 97377
305th St.

Featherstone Twp
Replace
No #
320th St.

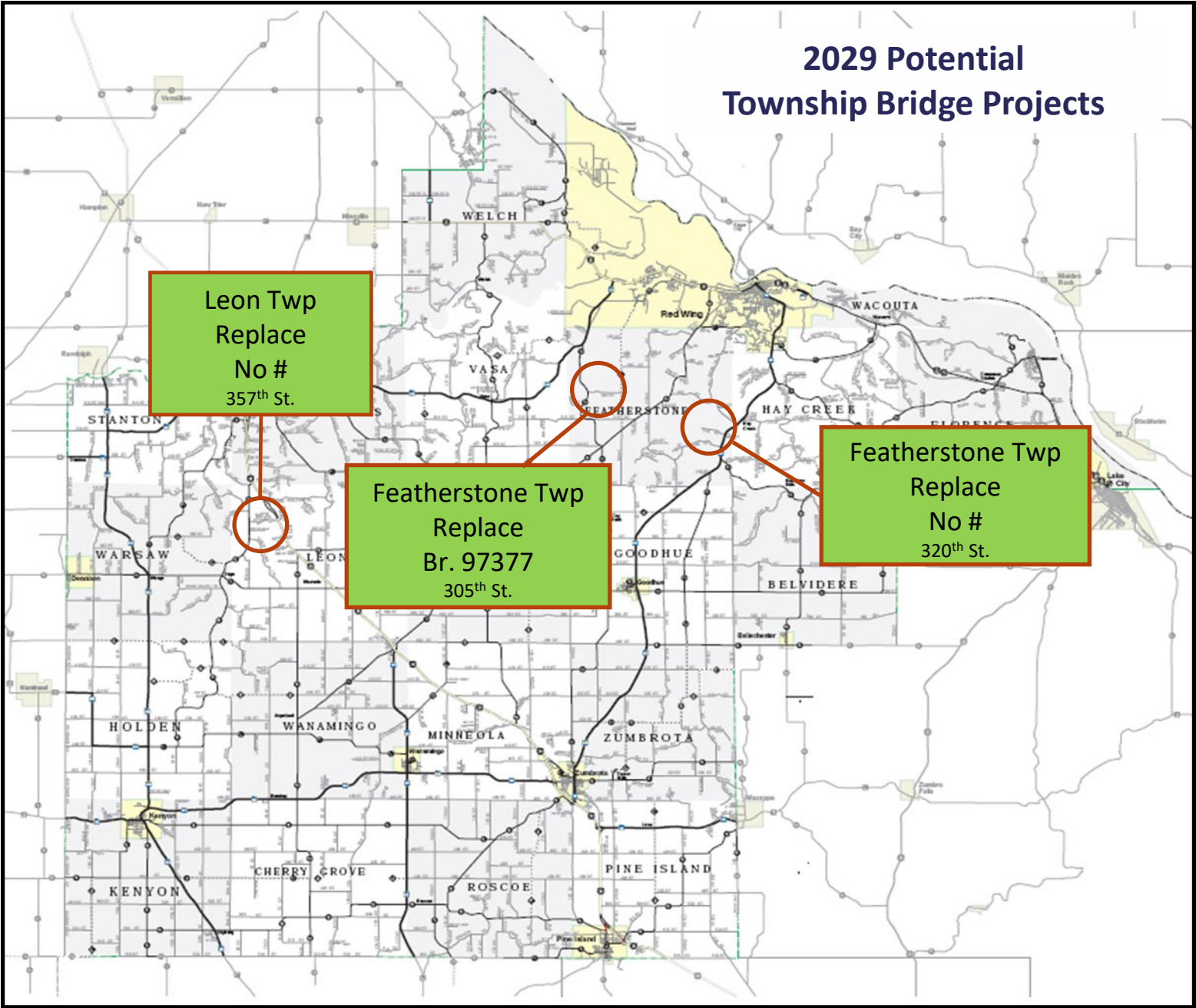

Staff Introductions

- Alex Dicke
 - Design Manager
- Cory Wersal
 - Construction Manager

Bridge Inspection Report Access

- There are 444 bridges in Goodhue County that require inspection.
- Inspections are completed every 12, 24, or 48 (box culvert) months.
- Most current bridge inspection reports are available online 24/7.
- [Web Reports \(state.mn.us\)](http://state.mn.us)

Public Works & City/Township Partnering

- Seal Coat and/or Crack Sealing & Paving
 - Invites were sent in September 2024
- Sand & Salt for Snow & Ice Control
 - Sand & Salt available for purchase from Goodhue County
 - Townships need to call schedule pick up w/GCPW

Road & Bridge Allotments

- 2024 Town Road Allotment \$625,845
 - Increase of 12%
- 2024 Town Bridge Allotment \$805,503
 - Increase of 51%
- 2025 allotments not available prior to meeting

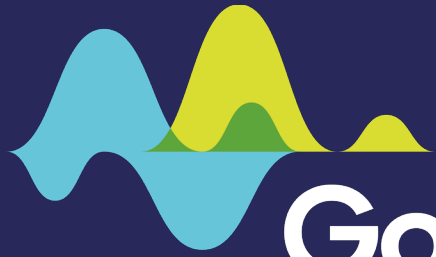

**Goodhue
County**
MINNESOTA

Land Use Management Updates

Welcome & Introduction

- Megan Smith, Land Use Management Director
- Divisions of Land Use:
 - Building Department (staff of 4)
 - Environmental Health (staff of 3)
 - Zoning (staff of 3)
- In 2024 the County re-organized the Land Use Department and split it into two departments:
 - Surveyor + Recorder + GIS = Surveyor/Recorder (Jeff Ekblad)
 - Building + Environmental Health + Zoning = Land Use (Megan Smith)

Topics Covered

County Department Re-Organization Update

Building Permits Data

Permit Reminders and Process Overview (Forms available)

Solar Regulations, Moratoriums, and Permits

Zoning Updates for Cannabis

Survey Results for Comp Plan (copies available)

Nitrates in groundwater (Environmental Health)

Building Permits

Goodhue County issues building permits for all unincorporated areas in Goodhue County, plus has contracts with the following jurisdictions: Bellechester, Cannon Falls, Dennison, Goodhue, Kenyon, Nerstrand, Wanamingo

In 2024, Goodhue County issued 441 permits in City limits, 469 permits in unincorporated areas for a total of 910 permits.

45 Ag permits were also issued 2,275 site inspections in 2024

2020 to 2024 Building Permit Data

Annual Permit Numbers and Valuations							
	City Permits		Township/County Permits		Total Permits		Inspections
Year	Permits	Value	Permits	Value	Permits	Value	
2020	364	\$16,268,000.00	435	\$21,759,000.00	799	\$38,027,000.00	2,631
2021	543	\$23,377,000.00	671	\$24,290,000.00	1214	\$47,667,000.00	2,836
2022	1414	\$28,633,000.00	915	\$24,621,000.00	2329	\$53,254,000.00	3,564
2023	549	\$14,222,000.00	517	\$19,709,000.00	1066	\$33,931,000.00	2,812
2024	441	\$10,108,000.00	469	\$21,035,000.00	910	\$31,143,000.00	2,275

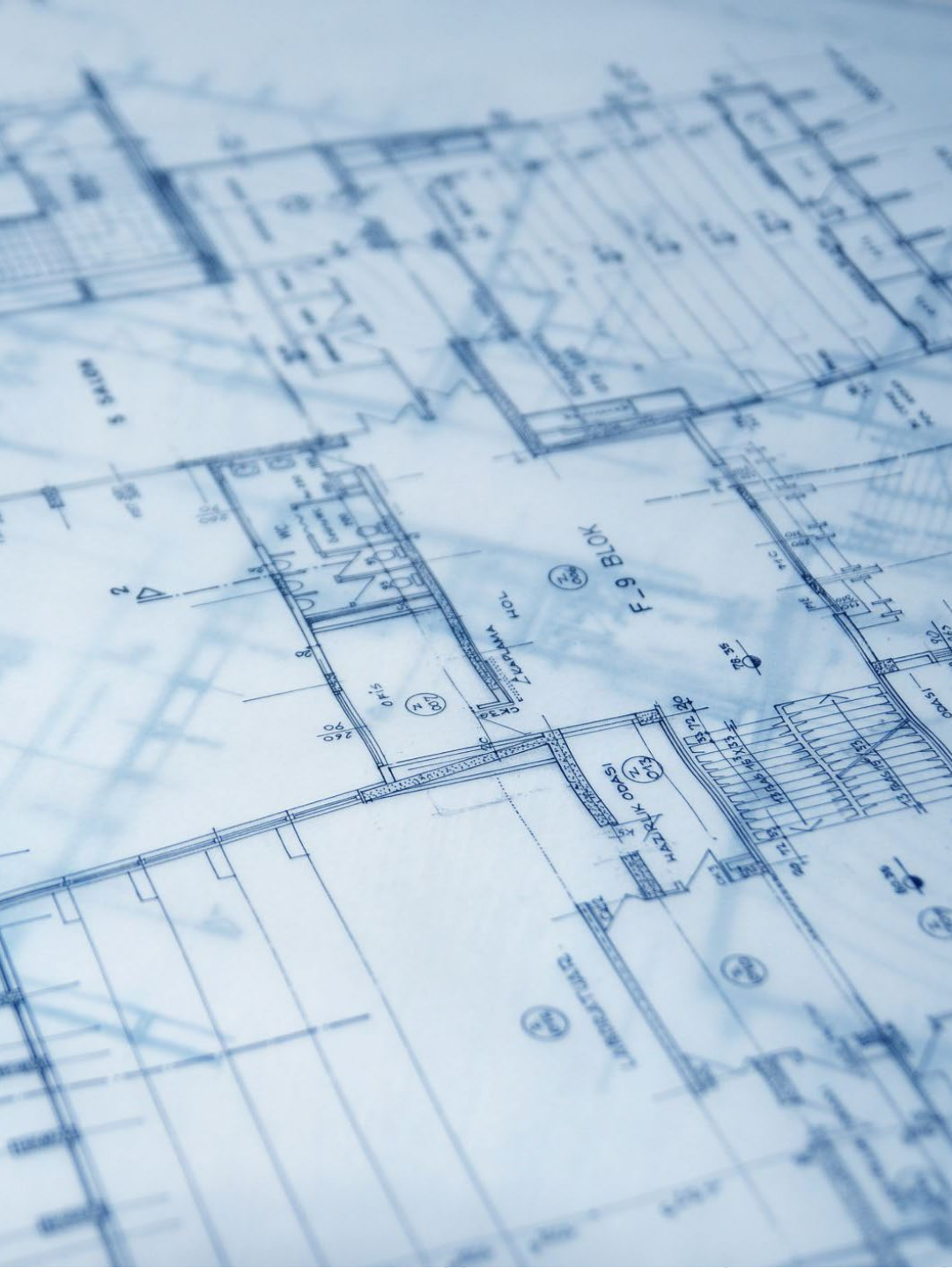

Building Permit Process Overview

- Building permits are considered administrative permits, which means they can be issued by the building official instead of the County Board, as long as ALL conditions are met and the project plans depict a project that meets building codes, zoning codes, and other applicable regulations.
- The county will not issue a building permit until the township has signed off on the permit.
- The county prefers township sign-offs are submitted with the application for a building permit or the permit process can be delayed.

Township Review Form

- This form is given to all applicants and is also available on the County's website

TOWNSHIP ZONING APPLICATION		TOWNSHIP NAME _____
Goodhue County		Parcel # _____
APPLICANT INFORMATION		
Last Name	First	M.I.
Street Address		Phone
City	State	ZIP
Email Address		
Township	Range	Section
PROJECT INFORMATION		
Site Address		
Property Owner:		
Type of Project	Proposed Use	
Structure Type	Replacement	YES <input type="checkbox"/> NO <input type="checkbox"/>
Variance #	Conditional Use Permit #	
Zoning District:	Lot size	Structure dimensions
DISCLAIMER AND SIGNATURE		
<small>I hereby apply for a zoning permit and I acknowledge that the information above is complete and accurate, that the work will be in conformance with the ordinances and codes of Goodhue County. The applicant also understands by signing this application he / she could be held responsible as representative of this project for any violation of compliance with all applicable laws and ordinances of Goodhue County. This permit may be suspended or revoked if the permit has been issued in error or on the basis of incorrect information supplied or in violation of any ordinance or regulation of Goodhue County. All provisions of law and ordinances governing this type of work will be complied with whether specified herein or not.</small>		
Signature	Date	
TOWNSHIP APPROVALS		
<small>I hereby certify by signing that I am authorized to act on the behalf of the Township Board, and the structure and use will meet all Township Codes and Ordinances if constructed as indicated.</small>		
Signature	Title	Date
Signature	Title	Date
Application fee	Receipt Number	Expiration Date

The granting of this permit does not exempt the permittee from having to secure other permits from other Local (Goodhue County), State, or Federal units of government which may have jurisdiction over portions of the authorized project.

Solar Permits

- Conditional Use Permit issued to Nokomis Energy on Highway 58 outside of Red Wing with Knobelsdorff as the contractor
- Two townships (Cherry Grove and Goodhue township) have passed moratoriums on solar installations
- 30 solar projects were permitted in 2024. Most were accessory uses to existing residential or agricultural uses

ProjectNotes	ApplicantCompany	AddressInfo	ParcelNumber	JurisdictionName
Roof Mounted (25 Panels)	Freedom Forever	629 First StreetKenyon, MN 55946	662200140	City of Kenyon
13.12 kW Roof Mounted Solar System	Three Rivers Contracting LLC	1309 Minnesota St WCannon Falls, MN 55009	526200030	City of Cannon Falls
SFD Roof Mounted Solar	Ambia Energy LLC	807 Hoffman Street WCannon Falls, MN 55009	521001390	City of Cannon Falls
Roof Mounted Solar on House & Garage	Wolf River Electric	201 Main Street WestCannon Falls, MN 55009	521002990	City of Cannon Falls
39 Roof Mounted Solar Panels	Freedom Forever MN LLC	31112 68th Avenue WayCannon Falls, MN 55009	523860020	City of Cannon Falls
Install a 40 kW Roof Mounted Solar Array	Solar Connection Inc.	41723 Highway 58 BlvdZumbrota, MN 55992	470091300	Zumbrota Twp
JONES SITE - Ground Mount Solar Garden	Knobelsdorff Electric Inc	29855 Hwy 58Red Wing, MN 55066	340081700	Hay Creek Twp
BULLARD SITE - 1 MW Ground Mount Solar Garden	Knobelsdorff Electric Inc	29857 Hwy 58Red Wing, MN 55066	340081700	Hay Creek Twp
Two Fixed Ground Mount Solar with Trenching	Blue Horizon Energy	46433 145th AvenueZumbrota, MN 55992	400040501	Roscoe Twp
Roof Mounted Solar Panels	Freedom Forever	22253 500th StreetPine Island, MN 55963	390230403	Pine Island Twp
Roof Mount Solar	All Energy Solar Inc	45674 10th AvenueKenyon, MN 55946	350321200	Holden Twp
15.3 KW Ground Mounted Solar Array	American Energy	39625 100th Avenue WayCannon Falls, MN 55009	370340600	Leon Twp
38kW AC Ground Mount Solar Array South of Hog Barn	MinnSolar Inc.	25497 390th StreetGoodhue, MN 55027	260290800	Belvidere Twp
38kW AC Ground Mount Solar Array	MinnSolar Inc.	37112 280th AvenueGoodhue, MN 55027	260230400	Belvidere Twp
Roof Mounted PV Solar	Wolf River Electric	51715 County 1 BlvdKenyon, MN 55946	300331001	Cherry Grove Twp
11.48kW, 28 Roof Mounted Solar Panels , 1 Inverter and Trenching	Freedom Forever MN, LLC	46761 222nd AvenueZumbrota, MN 55992	390022001	Pine Island Twp
32 Module Flush Roof Mount PV Solar Install	All Energy Solar Inc	37272 20th AvenueDennison, MN 55018	450211000	Warsaw Twp
Ground Mounted Solar Array	Cedar Creek Energy Corporation	45291 County 1 BlvdWanamingo, MN 55983	440320500	Wanamingo Twp
Ground Mounted Solar Array	Cedar Creek Energy Corporation	45679 County 1 BlvdWanamingo, MN 55983	440320600	Wanamingo Twp
Roof Mounted PV Solar	Wolf River Electric	13911 Sunset TrailWelch, MN 55089	420050100	Vasa Twp
16.8 kW Ground Mount Solar PV Installation	Centauri Systems, LLC	20740 County 4 BlvdZumbrota, MN 55992	470210101	Zumbrota Twp
PV Gound Mount Solar	Wolf River Electric	29439 115th AveCannon Falls, MN 55009	280120401	Cannon Falls Twp
37.5kW Ground Mount Solar Array	MinnSolar Inc.	26889 County 9Goodhue, MN 55027	260210400	Belvidere Twp
1 MW Solar Garden	Novel Energy Construction LLC	44992 Cty 168 BlvdZumbrota, MN 55992	380260700	Minneola Twp
Residential Ground Mounted Solar	Wolf River Electric	5901 315th Street WayCannon Falls, MN 55009	410240700	Stanton Twp
Roof Mounted PV Solar	Wolf River Electric	2345 S. Oak Dr.Red Wing, MN 55066	343000030	Hay Creek Twp
37.5kW Ground Solar Mount System	MinnSolar Inc	34645 240th AveGoodhue, MN 550274	330010500	Goodhue Twp
Roof Mount - 21 Module Flush	All Energy Solar Inc	45698 20th AvenueKenyon, MN 55946	350330401	Holden Twp
1.9MW 11 Acres Ground-mount Solar Array	Knobelsdorff Electric Inc	47499 240th Avenue WayMazeppa, MN 55956	390120600	Pine Island Twp
36 Ground Mounted Solar Panels	Wolf River Electric	31121 County 8 BlvdCannon Falls, MN 55009	280220100	Cannon Falls Twp

Cannabis

Cannabis zoning (county zoning districts, not cities)

Cannabis cultivation and medical cannabis cultivation is permitted in A1, A2, A3 and not permitted in R1 and conservation subdivision districts

Cannabis retailer is permitted in business districts and not permitted in industrial

See article 20 of the county's zoning ordinance for more permitted, not permitted uses for microbusinesses, mezzobuisness, manufacturing, wholesaling, transportation, testing services, deliver services, processing, and low potency hemp

Cannabis in County Business and Industrial Districts

Use	B	I
Cannabis Microbusiness	P	P
Cannabis Mezzobusiness	P	P
Medical Cannabis Combination Business	P	P
Cannabis Cultivator	P	P
Cannabis Manufacturer	NP	P
Cannabis Wholesaler	P	P
Cannabis Transporter	P	P
Cannabis Testing Facility	P	P
Cannabis Delivery Service	P	P
Medical Cannabis Cultivator	P	P
Medical Cannabis Processor	P	P
Lower-Potency Hemp Edible Manufacturer	NP	P
Lower-Potency Hemp Retailer	P	NP

Comprehensive Plan Township Survey Results

- Copies available for of full results (hard & email as PDF)

 Building – Environmental Health – Zoning Departments
509 West 5th Street, Red Wing, MN 55066
651-385-3104

County staff sent the below survey to all 21 Goodhue County Townships. 12 Townships sent responses.

Question 1:
The existing density rules are:

- Too restrictive **3**
- Not restrictive enough **1**
- Restrictive Enough **8**

Question 2:
Goodhue County's A2 zoning allows 12 dwellings per section. Would your Township would like to see the number of dwellings in A2:

- Increase **1**
- Leave at 12 **10**
- Other/Comments **1**

Question 3:
Should the A-2 District allow more than one dwelling per ¼ section if the overall section density has not been met?

- Yes **2**
- No **9**
- Unsure **1**

Question 4:
The availability of building sites in your Township is:

- Too Many **0**
- Just Right **11**
- Not Enough **1**
- Unsure **0**

Question 5: *This question may have been confusing because we were asking where subdivisions should be placed, not whether the Township wanted residential subdivisions. Almost all Townships would agree residential subdivisions should be away from feedlots etc. Rural residential subdivisions should be encouraged in appropriate areas (away from large feedlots, on paved roads, near city limits, etc.).*

- Strongly Agree **3**

To Effectively Promote the Safety, Health, and Well-Being of our Residents

Survey Results – solar questions

Question 11: Utility Scale Solar Energy Systems are typically located on existing cropland. Goodhue County does not restrict solar development on prime agricultural land. Should Goodhue County restrict the number of acres of prime agricultural soils that may be impacted by solar development?

Yes	(10)
No	(0)
Unsure	(2)

Question 12: If YES what would be an acceptable number of acres of prime farmland impact with the knowledge that the average solar garden is approximately 8 acres of fenced area.

0 acres of prime farmland	(5)
less than 1 acre of prime farmland	(1)
1 to 2 acres of prime farmland	(2)
3 to 5 acres of prime farmland	(2)
6 or more acres of prime farmland	(0)



Goodhue County

Land Use Management

Federal Environmental Protection Agency Declaration



Petition and EPA response

- The Minnesota Center for Environmental Advocacy and several other community organizations filed a emergency petition regarding Nitrate Contamination in the Southeast Karst Region of Minnesota Including Goodhue County
- The EPA responded with a letter to MN agencies directing them address Nitrate contamination

What are Nitrates?

- Nitrate is a compound that naturally occurs and has many human-made sources.
- Nitrate is in some lakes, rivers, and groundwater in Minnesota.
- You cannot taste, smell, or see nitrate in water.
- **Consuming too much nitrate (concentrations above 10 ppm or mg/L) can be harmful—especially for babies.**

Quick nitrate math

- 10 ppm or mg/L MCL set to $\frac{1}{2}$ the level where there were no observed cases of methemoglobinemia
 - Parts per million, milligrams per Liter and Maximum contaminant level
- Compare to preserved meats
 - Hotdogs about 5 mg per dog
 - Bacon about 1 mg per slice of bacon

Why South Eastern MN?

- SE MN has Karst topography which has cavities connecting the surface to groundwater
- The geology and activities on the land surface in southeast Minnesota make it more likely for nitrate to be at concentration above 10 ppm in groundwater.
- Nitrate in groundwater is not a new issue; this situation has been forming for several decades.

New Developments

<https://safe-drinking-water-for-private-well-users-gis-olmsted.hub.arcgis.com/>

- Free nitrate testing available through the TapIn program
- Application for reverse osmosis water treatment and other technical assistance



TAP IN

SAFE DRINKING WATER FOR SE MN

New Developments

- MDH funds for County Wide well inventory
- MDA pesticide testing

GOODHUE SOIL AND WATER CONSERVATION DISTRICT

Goodhue SWCD is your local government contact for questions and concerns relating to:

- Feedlot Program
- Soil Erosion issues
- Cost-Share Incentives for dams, waterways, Cover Crops, fixing erosion/gullies, Feedlot Fixes, etc.
- Tree Program
- Drainage concerns
- No-till Drill
- Wetland or Stream Buffer Regulations
- Habitat or Set-a-Side Programs



GOODHUE COUNTY WETLAND CONSERVATION ACT (WCA) LOCAL GOVERNMENT UNIT (LGU)

Questions or concerns regarding Wetland Rules in your townships

- Site visits
- Clarity of the law with potential wetland impacts with landowners or your road projects

Contact: Ben Dvorak, Natural Resource Specialist

- › <https://www.goodhueswcd.org>
- › 651-923-5286 ext. 105
- › Ben.Dvorak@goodhueswcd.org



GOODHUE COUNTY FEEDLOT UPDATE

MN's Regulatory Feedlot 7020 Program includes & optional management between the Minnesota Pollution Control Agency (MPCA) and the County Government. The County Feedlot Programs increase a local service for livestock producers.

County Feedlot Program administers the MN Feedlot 7020 rules and regulations with sites/feedlots that range from 10au-999au. Also regulates Goodhue County Article 13 Confined Feedlot Regulations Ordinance.

About 1,100 sites registered as Feedlots in Goodhue County. The sites range from 10 Animal Units (AU) and over.



GOODHUE COUNTY FEEDLOT UPDATE

The Feedlot Coordinator tasks include:

- Compliance Inspections- ~ 70 inspections/year
- Permitting
- Complaints/Manure Spills etc.
- Emergency Response
- Updating Feedlot Registrations
- Owner Assistance
- Education

Contact the Feedlot Compliance Coordinator:

www.goodhueswcd.org

Email: kpetit@goodhueswcd.org

Phone: (651-923-5286 Ext. 111)



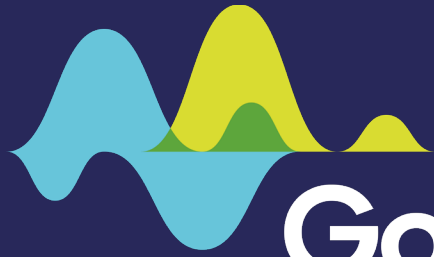

**Goodhue
County**
MINNESOTA

Finance & Taxpayer Services

Finance Director/Auditor/Treasurer
Lucas Dahling

Agenda

- New for 2025 - Cannabis Retail Registration
- 2024 General Election Turnout
- 2025 March Township Elections
- 2025 Local Board of Appeals
- 2025 Quintile Areas

Cannabis Retail Registration

Rollout of legal cannabis sales to be effective this year:

- Anyone who engages in the retail sale of cannabis, hemp, cannabis derived products, or hemp derived products within Goodhue County must first obtain a license from the Office of Cannabis Management (OCM), and then obtain a Retail Registration from the County.
- Limited to no more than one retail registration for every 12,500 residents, so a maximum of four retail business locations in Goodhue County.
- Official Rollout Date is TBD by OCM.

Cannabis Retail Registration

Simplified State License/County Registration Process:

- Step 1 – Apply for state license with OCM (includes background check)
- Step 2 – OCM issues preliminary approval to applicant
- Step 3 – Applicant provides business location
- Step 4 – OCM forwards application to Local Government (Goodhue County)
- Step 5 – County certifies zoning, fire, building code compliance
- Step 6 – OCM conducts site inspection
- Step 7 – OCM issues license
- Step 8 – Licensed business applies for Retail Registration with County
- Step 9 – County approves and issues Retail Registration
- Step 10 – Licensee can now begin retail sales

Cannabis Retail Registration

Documents required with Retail Registration Application:

- Copy of valid state license or written notice of OCM license preapproval
- **Township Board written approval**
 - Similar requirement to Liquor Licenses
 - Town Boards have no authority to deny retail registration (must approve request)
- City written approval if located within a city that has delegated registration authority to Goodhue County
 - Similar requirement to Liquor Licenses
 - City Councils have no authority to deny retail registration (must approve request)
- Application Fee (varies by specific license type)
- Proof of insurance

General Election Turnout (2016-2024)

Year	Registered Voters at 7am	Total Voters	Voter Turnout (%)	Absentee Ballots	Absentee Ballots %
2016	28,323	25,929	92%	4,148	16%
2018	28,761	23,340	81%	3,921	17%
2020	30,731	28,759	94%	11,158	39%
2022	31,595	23,211	73%	3,739	16%
2024	32,038	28,949	90%	6,660	23%

Observations:

- 2024 had the highest number of total votes, but less votes than 2020 as measured as a percentage of registered voters at 7am.
- Nearly a quarter of all votes were made via absentee ballots. This is less than 2020, but still a significant amount.
- Belvidere Twp. and the City of Dennison tied for the highest turnout rate at 96%.
- Lowest turnout rate was Red Wing W-4 P-1 at 81%.

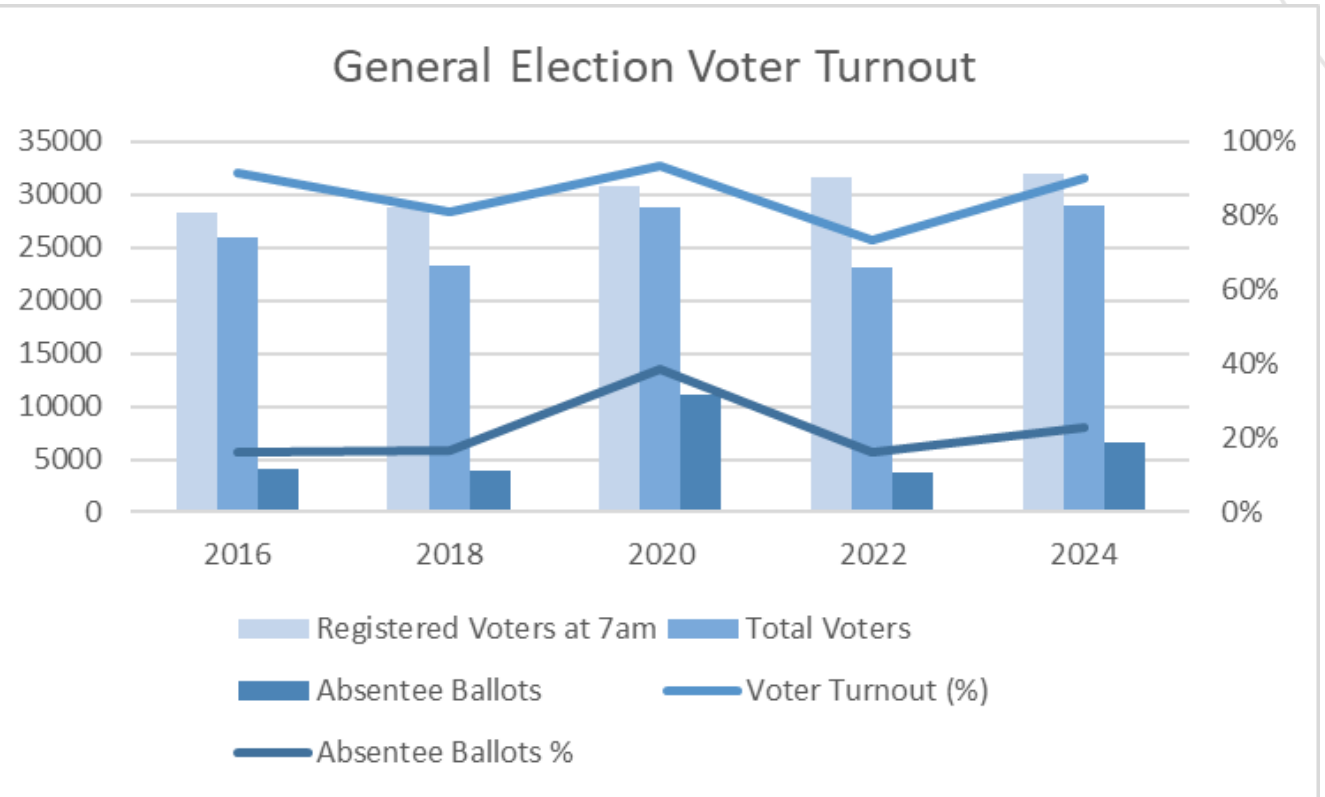

March Township Elections

New – Absentee Ballot Witness

- Starting January 1, 2025, those who can serve as a witness for a person's absentee ballot are:
 - A person who is at least 18 years of age on or before the day of the election and must be a U.S. citizen (no longer requires person to be MN Resident)
 - A notary public
 - Individual authorized to administer oaths

New – Permanent Absentee

- June 1, 2024 voters with permanent absentee voter status will automatically be sent an absentee **ballot**. This replaces the list to automatically receive an absentee ballot *application*.
 - We will provide the names of those who will automatically receive a ballot (approx. 170 for townships)
 - Keep this in mind when ordering ballots for those townships that must use the OmniBallot

March Township Elections

New – Tribal Requests

- County/Township can receive a request from a federally recognized Indian Tribe and provide an absentee/early voting location on the Indian reservation for at least one day. The location must be a mutually agreeable site that is accessible by public road.
- Temporary absentee voting locations must be designated at least 47 days prior to election day. **Deadline was 1/23/2025 this year.**
- The day(s) can be scheduled anytime within the 46 days before election day.
- County has communicated with the Prairie Island Indian Community about this. They will reach out to townships to make this request.

March or November Elections



MARCH

- Candidate Filing – Township
- Publications/Notices – Township
- Ballots – Township/County
- Absentee Voting - Township
- Equipment Testing – Township
 - Canvassing – Township



NOVEMBER

- Candidate Filing – Township
- Publications/Notices – Township
 - Ballots - County
- Absentee Voting – County
- Equipment Testing – County
- Canvassing – Township
- **One Less Election=Savings!!**

Moving to November Elections

Conversion Process:

- Initiated by town board or town electors
 - *Town Board*: Pass a resolution or ordinance designating 1st Tues. after 1st Mon. in Nov. of either even or odd-numbered year as date of town general election
 - Includes plan to shorten or lengthen terms of office
 - *Town Electors*: Pass a resolution at annual town meeting posing question of moving to Nov. election with proposed transition schedule
 - Town electors submit the ballot question to move the election to go before the voters at the next town general election
- Place question on ballot
- Implement Nov. Elections if ballot question passes
- Adjustment of the elections schedule

Town Question 1 – Whether to Move the Town Election to November

Shall the first Tuesday after the first Monday in November be designated as the date of the _____ Township general election?

MN Association of Townships Guide - <https://www.mntownships.org/information-library/elections>



Local Board of Appeals

Local Board Meetings:

- Local Meetings scheduled from April 16th to 29th, 2025
- Meeting notices have been mailed to Township Clerks
- Must have at least one certified member at the hearing
 - Certified person must be in attendance
 - Certification training is available here:
<https://www.revenue.state.mn.us/board-appeal-and-equalization-training>
- **Training must be completed by TODAY Saturday, February 1st**

Open Book Meetings:

- Held at Goodhue County Government Center
 - Belvidere Twp
 - Florence Twp
 - Holden Twp
 - Roscoe Twp
 - Zumbrota Twp
 - Wacouta Twp
- Taxpayers should reach out to the Assessor's Office prior to attending the Open Book meeting

Quintile Areas

- On-site property reassessment will take place in the following areas:
 - Belle Creek Twp
 - Cannon Falls Twp
 - Stanton Twp
 - Vasa Twp Twp
 - Welch Twp
 - Cannon Falls City
 - Dennison City
- Appraisers will be updating photos and verifying measurements in the above-mentioned areas in 2025 for the 2026 assessment.
- Appraisers will knock on doors and leave business cards if property owner is unavailable.

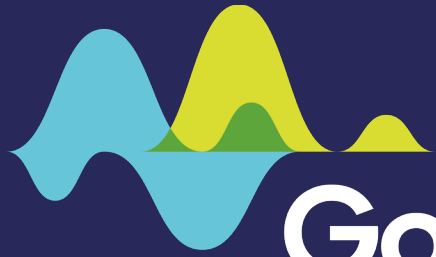

**Goodhue
County**
MINNESOTA

Stephen O'Keefe

Goodhue County
Attorney's Office

County Attorney Statistics 2014-2024

Felony and Gross Misdemeanor Criminal Cases

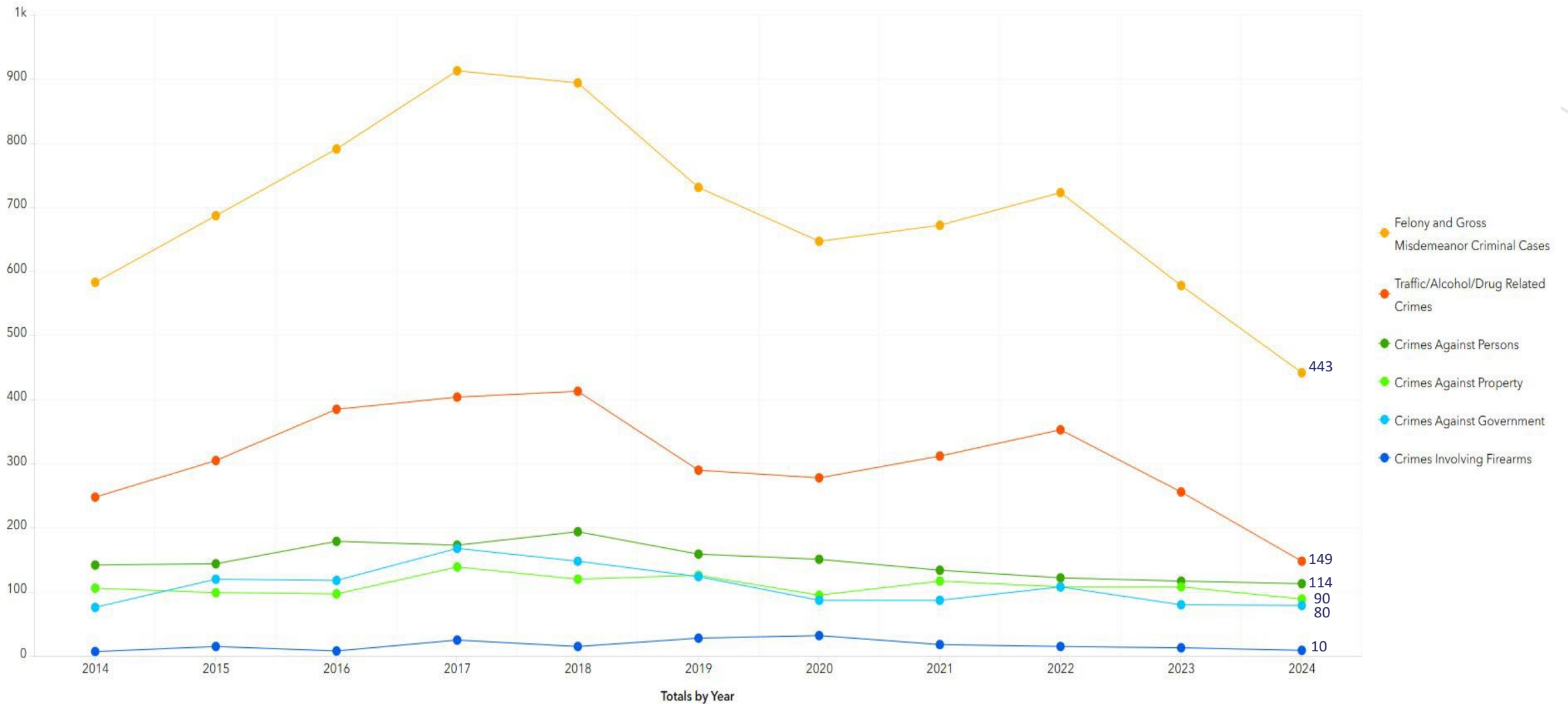

County Attorney Statistics 2014-2024

Controlled Substances Crimes

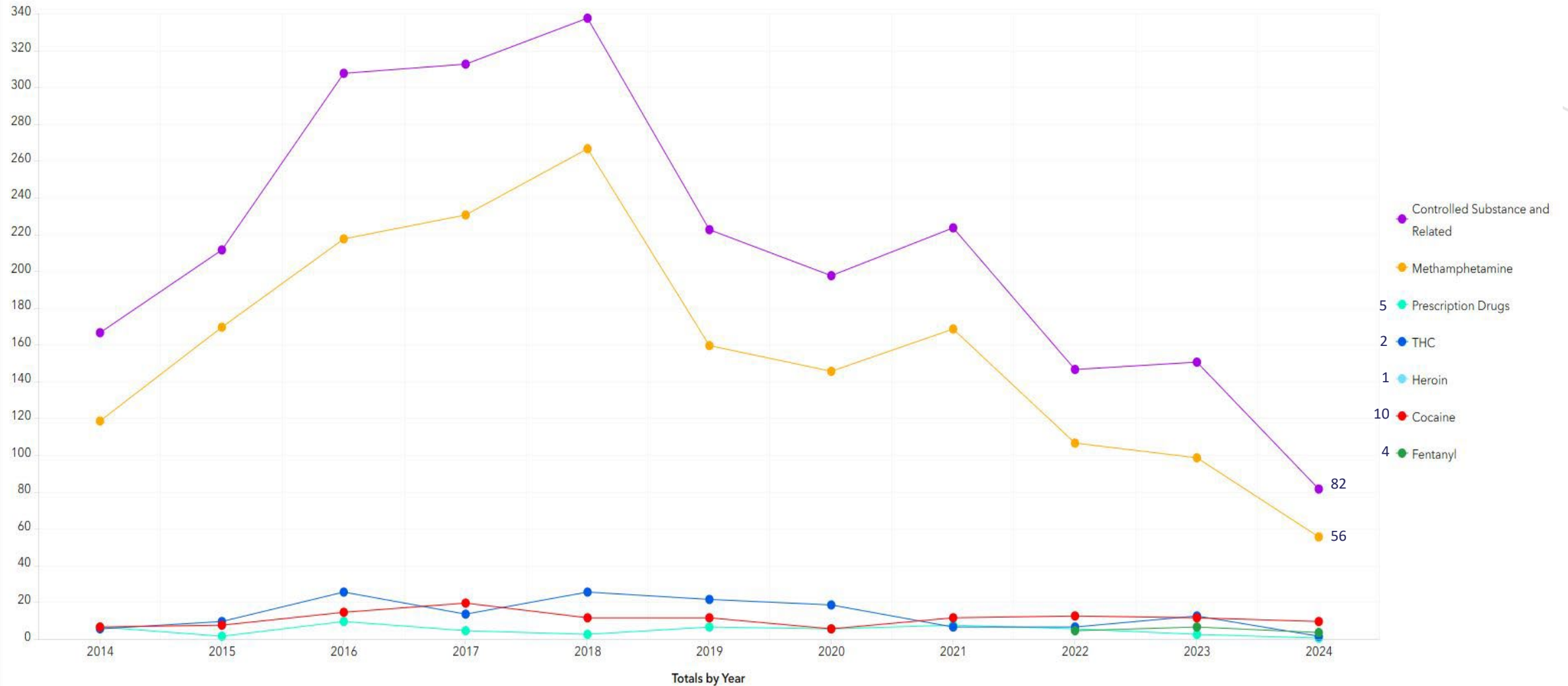

County Attorney Statistics 2014-2024

Juvenile Cases

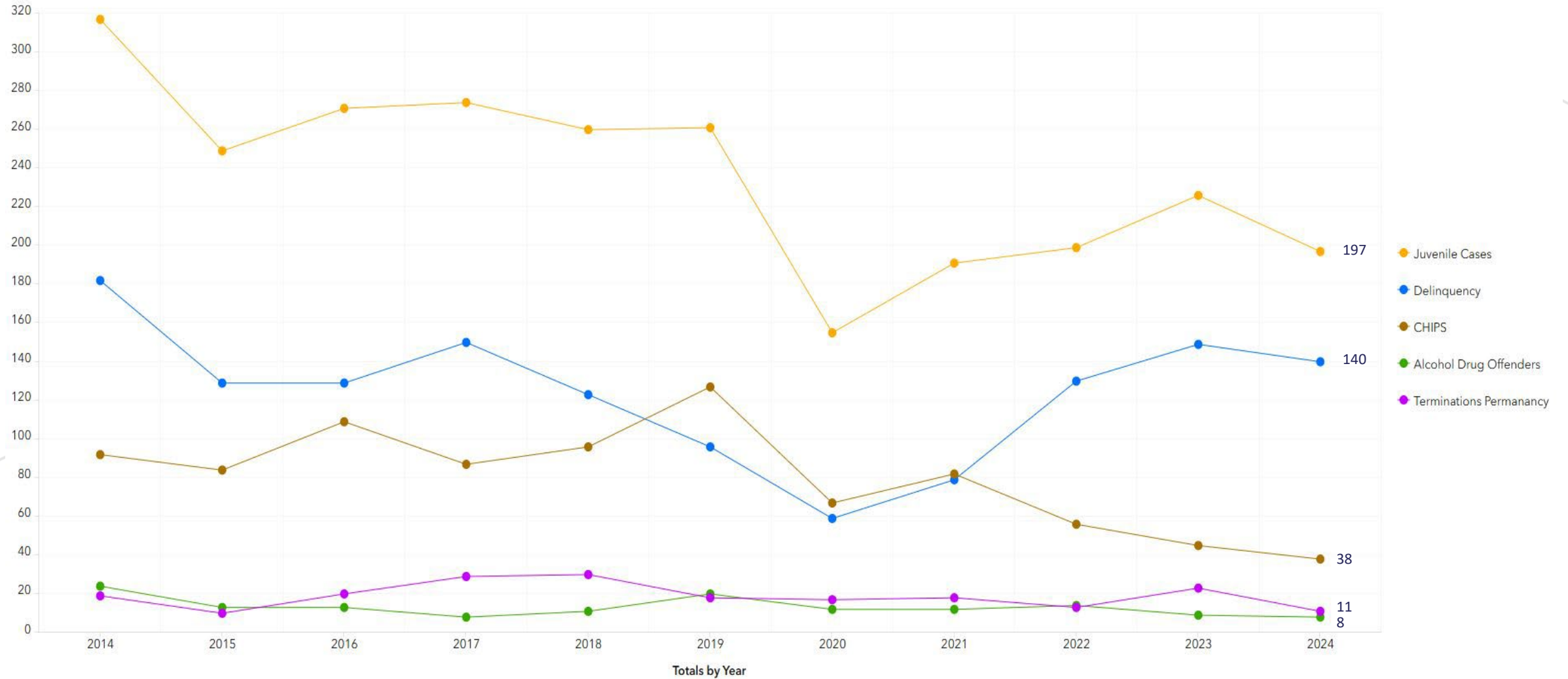

County Attorney Statistics 2014-2024

Other Case Types

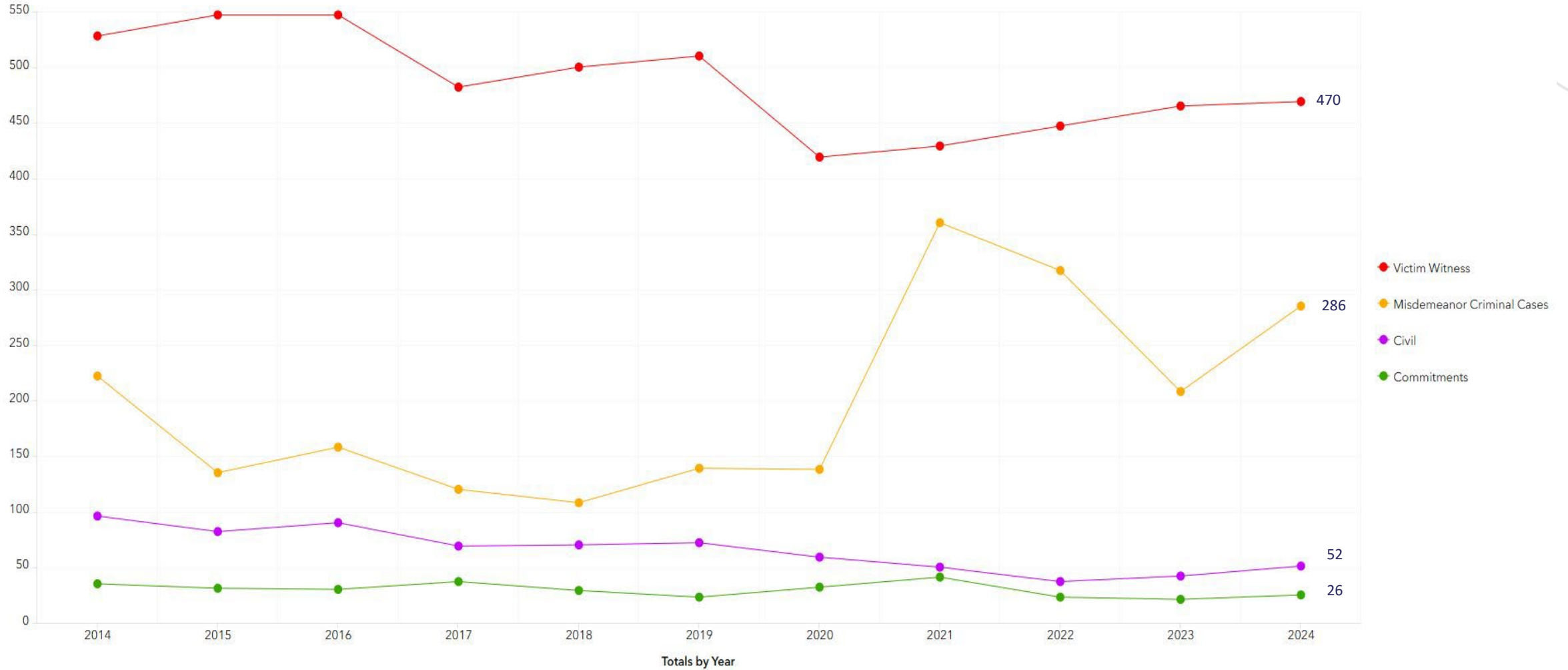

TREATMENT COURT UPDATE

- Began in 2019 under Federal grant; transition to a state funding beginning of 2024
- 6 phases, minimum of 19 months of commitment to program;
- Treatment, drug testing minimum of 2 times/week, frequent in court appearances
- 12 current participants (1 on warrant status)
- 203 referrals made since start of treatment court; 3 pending referrals
- 54 participants in Goodhue County Treatment Court thus far
- Since beginning in 2019, 27 graduations from Goodhue County Treatment Court; 8 graduates admitted to a relapse, 3 committing new offenses post-graduation
- Since beginning in 2019, 15 participants have been terminated due to non-compliance and criminal sentences were executed
- Almost all current participants have obtained gainful employment, housing, and valid driver's licenses since being out of treatment or during their step-down program; all are engaged in some form of community support groups to sustain long term success.

QUESTIONS?